

### SHOP LIST

Restaurants serving Noppui dishes (all in Ichikawamisato Town)		
1 Restaurant New Port (Reservation required)	1729-1 Ichikawadaimon	055-272-5051
2 Hometown tasty Kitchen Miharashi-tei	2608 Otsuka	055-272-2641
3 Kappo Kasai	2602-3 Ueno	055-272-5166
4 Toda Shokudo	2836-2 Ueno	055-272-0442
5 Daimon-ken	952 Ichikawadaimon	055-272-0269
6 Uozen	953 Ichikawadaimon	055-272-0050
7 Miyoshi Shokudo	717 Ichikawadaimon	055-272-0806
8 Kikaku	467-1 Ichikawadaimon	055-272-4120
9 Kawachi	2021 Iwama	0556-32-2333
10 Ameya	1991 Iwama	0556-32-3158

### The Ichikawamisato Town Chamber of Commerce and Industry

173 Ichikawadaimon, Ichikawamisato Town, Nishiyatsushiro District, Yamanashi 409-3601 TEL.055-272-4711

[http://www.shokokai-yamanashi.or.jp/~ichi\\_sato/](http://www.shokokai-yamanashi.or.jp/~ichi_sato/)

平成28年度小規模事業者地域力活用新事業全国展開支援事業



# TRIP

## Ichikawamisato

ICHIKAWADAIMON • MITAMA • ROKUGO



A trip to experience the two major traditional crafts  
[Washi / Seal Stamp]

Ichikawamisato Town, Yamanashi

ICHIKAWAMISATO TOWN YAMANASHI PREF.



## A trip to experience making two major traditional crafts of Ichikawamisato Town

Ichikawamisato Town has traditional crafts, "Ichikawa hand-made Japanese paper" and "Koshu hand-carved seal stamps" which were certified by national government and prefecture, and its manufacturing technique was handed down from generation to generation to the present. We recommend you to try making these handmade craft.

### Experience for making hand-made Ichikawa Washi

The papermaking-industry has flourished since 150 years before Sei Shonagon wrote "Makura no soshi", the first essay in Japan. It is called "Hadayoshi-gami," Ichikawa Washi which was the official paper for the Takeda clan and the Tokugawa clan have established the machine-papermaking technology by a major technical innovation and became the center of the local industry that boasts the largest share in Japan in shoji paper. The handmade paper know-how has been passed down from generation to generation, has been maintained until today.

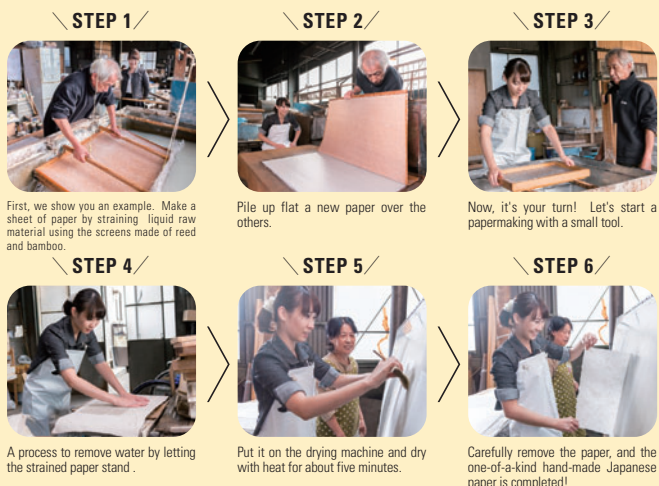

Mr. Hideo Toyokawa of Toyokawa Seishi Factory. He is the holder of Ichikawamisato Town intangible folk-culture property.

Hands-on classes and tours are available!

Reservations required

Successors wanted!!

Please contact / The Ichikawamisato Town Chamber of Commerce and Industry  
☎055-272-4711 (Weekdays 9:00~16:30)



Toyokawa Paper Mill. Hands-on experience is available.



Hand-made Washi products



Ichikawa Washi Processors Cooperative Associations

## A trip to enjoy the ultimate fireworks

The origin of Ichikawa fireworks is believed to be a "beacon" in the period of Lord SHINGEN TAKEDA. In the Edo period, a big fireworks set off on July 20, that is the anniversary of the death of Jinzaemon who is the founder of the Ichikawa hand-made Japanese paper. This fireworks was one of the three largest fireworks in Japan. The name of the "Shinmei Fireworks" revised in 1989 came from the "Shinmeisha" which enshrines Jinzaemon as a God of paper, and approx. 20,000 fireworks light up the night sky on August 7 every year.



### Seal-engraving experience in the best seal stamp village in Japan

The seal stamp industry has been flourishing in Rokugo area in Ichikawamisato Town since the Meiji Period, and the town has grown as "Japan's best village of seal stamp" in techniques, history, and production output. The expert skills and sense of human hand cannot be built overnight, and it is the glory of Rokugo that we have the accumulation of skills which can meet the exact requirements and many masters and experts in engraving and seal stamp carving were produced from Rokugo.



Mr. Akio Ito who is the President of the seal stamp carving section of the Rokugo Seal Stamp Association Union.

Hands-on classes and tours are available!

Reservations required

Successors wanted!!

Please contact / The Ichikawamisato Town Chamber of Commerce and Industry, Rokugo Office  
☎0556-32-2159 (Weekdays 9:00~16:30)  
The Ichikawamisato Town Chamber of Commerce and Industry (Please refer to the left for details.)

Experience facility is here / Insho Shiryokan (Museum of Seal Stamp)

☎0556-32-2159  
2160 Iwama, Ichikawamisato Town  
Weekdays: 9:30~17:00  
Weekends: 10:00~15:00  
※ Closed on Saturdays, Sundays, and Holidays from December to March.



Insho Shiryokan (Museum of Seal Stamp)



Seals can be purchased at the museum.

## A trip to step back in time in Ichikawamisato Town



Just strolling around the town which still has the scenery and buildings reminiscent of the old days, you can enjoy a fresh feeling as if you step back in the Showa period. Also, Ichikawamisato Town is well known as the birthplace of Kai-Genji, and visitors can think of the old days.



Historic site of Kai-Genji



Remains of Ichikawa-jinya

## A trip to eat specialties of Ichikawamisato Town



The "Noppui menu" developed by the chamber of commerce and industry in town made with local specialty vegetables, Otsuka carrots and Kan-Kan Musume corn, can be enjoyed mainly during winter. "Anbin" which was loved as a snack during a break from farming work is also popular.



Noppui Menu



Anbin rice cake

## A trip to get warm to the bone in Ichikawamisato Town



Mitama Hot Spring is proud of the view of mountains and a sparkling night scenery of Kofu basin seen from the open-air bath. TSUMUGI-DAY-SPA has a good reputation for its spring quality. It is equipped with the rehabilitation bath and recommended for therapeutic bath. How about come and spend a wonderful time feeling free and relax in the water?



Mitama Hot Spring / ☎055-272-2641  
2608 Otsuka, Ichikawamisato Town  
Closed: Open daily (Closed about 5 days in a year)  
Hours: 10:00 ~ 23:00  
(last admission is 30 minutes before closing)



TSUMUGI-DAY-SPA / ☎0556-20-2651  
640 Kamogaritsumugi, Ichikawamisato Town  
Closed: On Wednesdays  
(next day when Wednesday is a holiday)  
and New Year's Day  
Hours: 10:00 ~ 20:00 (last admission at 19:30)



Former Futabaya Sake Brewery

☎055-272-0218

Hobundo (reservations required)  
1170 Ichikawadaimon, Ichikawamisato Town  
Registered tangible cultural properties by the Agency for Cultural Affairs



Daimon Hirin Park

☎055-272-7100

4930 Ichikawadaimon, Ichikawamisato Town  
Closed: On Mondays (next day when Monday is a holiday and December 27~January 4)  
Hours: 9:30~17:00 (last admission at 16:00)



Places on street corner



Kakinoki no Tsuji



Chuhoku no Idobata

## A trip to experience the nature of Ichikawamisato Town



In town, there are many tourist attractions which are abundant with nature and popular among family and young visitors. Trekking, trail running, night views, and starry sky... There are lots of variation to enjoy the town.



Lake Shibireko

The lake offers seasonal scenery such as cherry blossoms, new leaves of tender green, autumn leaves, and the frozen lake. It is also recommended for outdoor activities such as camping and paddle boating.



Mt. Hirugatake

The view from the top of the mountain is splendid, and a panoramic view of Mt. Fuji, Yatsugatake mountains, Okuchichibu, Mt. Kitadake, and Mt. Ainodake are spread before your eyes.

### EVENT INFORMATION



Botan no Hana Festival

The period of event / Late April Location / Kabuki Culture Park  
Approximately 2,000 colorful peonies can be enjoyed in the Kabuki Bunka Park which was developed commemorating the birthplace of Danjuro ICHIKAWA.



Shinmei Fireworks Festival

The period of event / August 7 Location / Riverside of Fuefukigawa River below Sangun Bridge  
A largest size fireworks festival in Yamanashi. Approx. 20,000 fireworks including a large-bloomed "two-shaku fireworks ball" and theme fireworks are displayed.



The best seal stamp in Japan: Fall festivals in the village of Rokugo

The period of event / Early November Location / Rokugo Elementary School  
A stamp seal festival held in Rokugo area where produces the top amount of seal stamps in Japan.  
Insho Kuyosai / October 1 Location / Fujimi Fureai no mori Park



Otsuka carrots harvest festival

The period of event / On Saturday in early December Location / Mitama Hot Spring  
"Otsuka carrots" that long ones are over one meter are directly sold by farmhouses. Also events such as sample tasting and local specialties sales are held at the festival.

